

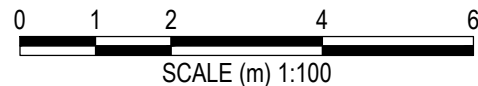

DRIVEWAY PLAN

SCALE 1:100



- 14.236
- SPOT POINT
 - ALIGNMENT
 - BOUNDARY LINE

LEGEND PROPOSED

DRAWINGS TO BE PRINTED IN COLOUR

REV	DATE	AMENDMENT / REVISION DESCRIPTION	TITLE	NAME
A	14/01/2025	ISSUED FOR DA - DRIVEWAY	DRAWN	JP
B	06/06/2025	ISSUED FOR DA	DESIGNED	JP
			DRG CHECK	PH
			DESIGN CHECK	PH
			APPROVED	PH

IF IN DOUBT, ASK

HYVE DESIGNS

ISSUED FOR DA				
SITE ADDRESS 23 CHELMSFORD AVE, BANKSTOWN				
CLIENT MINH TRAN				
DRIVEWAY PLAN				
<small>THIS DRAWING AND THE INFORMATION CONTAINED THEREON HAVE BEEN CREATED SOLELY FOR A PARTICULAR PURPOSE AND CLIENT. THIS IS PROTECTED BY COPYRIGHT. YOU MAY NOT REPRODUCE ANY OF IT IN ANY FORM WITHOUT THE WRITTEN PERMISSION BY HYVE DESIGNS PTY LTD. IF YOU DO, YOU MAY HAVE TO PAY FOR DAMAGES TO HYVE DESIGNS PTY LTD OR YOU MAY BE PROSECUTED.</small>				
JOB NUMBER: 24217	DATUM AHD	SCALE A3, 1:100	SHEET No DR01	REV B

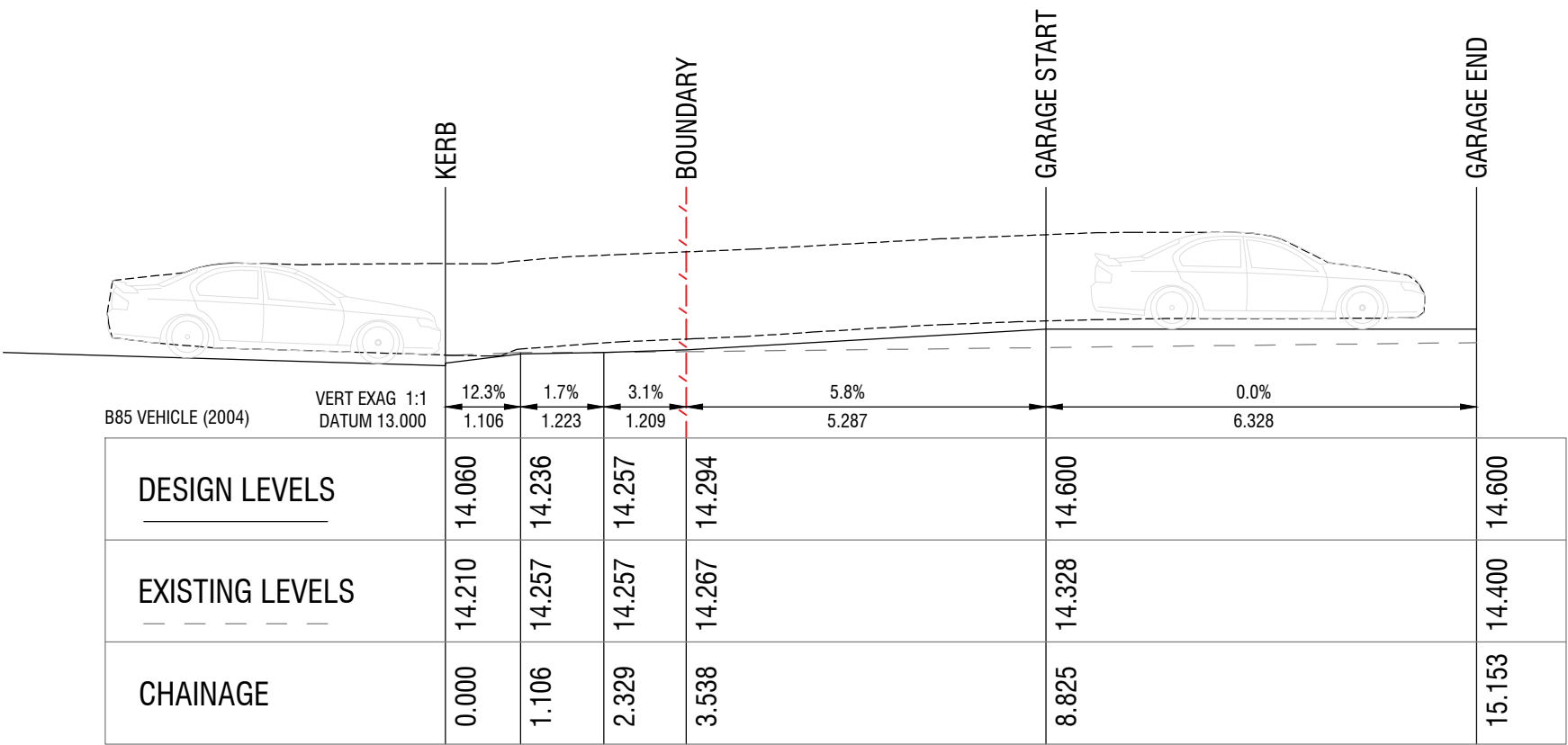

CENTRELINE ALIGNMENT LONG SECTION
SCALE 1:100

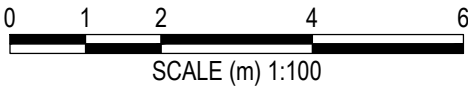

DRAWINGS TO BE PRINTED IN COLOUR

REV	DATE	AMENDMENT / REVISION DESCRIPTION	TITLE	NAME
A	14/01/2025	ISSUED FOR DA - DRIVEWAY	DRAWN	JP
B	06/06/2025	ISSUED FOR DA	DESIGNED	JP
			DRG CHECK	PH
			DESIGN CHECK	PH
			APPROVED	PH

IF IN DOUBT, ASK



ISSUED FOR DA

SITE ADDRESS 23 CHELMSFORD AVE, BANKSTOWN				
CLIENT MINH TRAN				
LONG SECTIONS (SHEET 1 OF 2)				
THIS DRAWING AND THE INFORMATION CONTAINED THEREON HAVE BEEN CREATED SOLELY FOR A PARTICULAR PURPOSE AND CLIENT. THIS IS PROTECTED BY COPYRIGHT. YOU MAY NOT REPRODUCE ANY OF IT IN ANY FORM WITHOUT THE WRITTEN PERMISSION BY HYVE DESIGNS PTY LTD. IF YOU DO, YOU MAY HAVE TO PAY FOR DAMAGES TO HYVE DESIGNS PTY LTD OR YOU MAY BE PROSECUTED.				
JOB NUMBER: 24217	DATUM AHD	SCALE A3, 1:100	SHEET No DR02	REV B

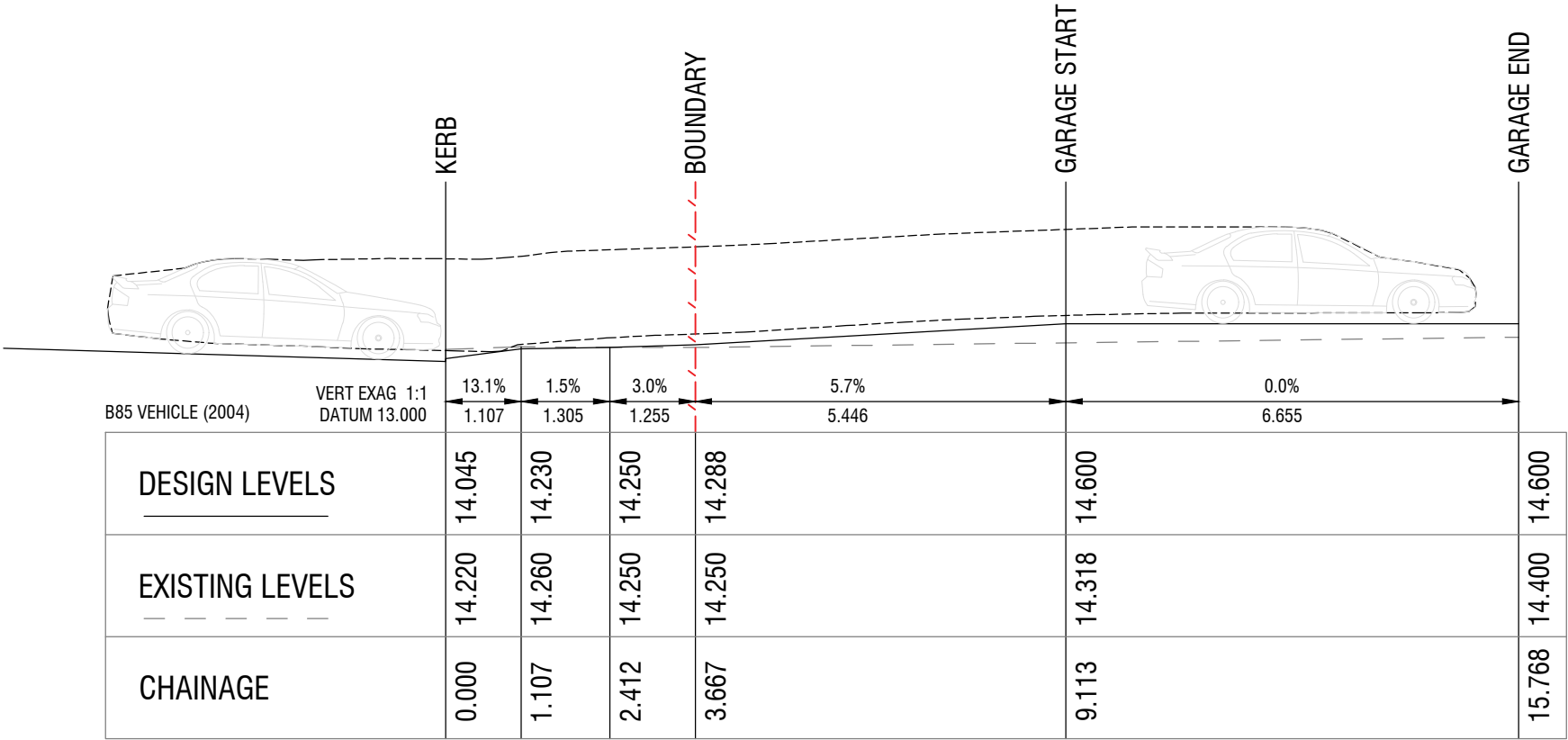

LHS ALIGNMENT LONG SECTION
SCALE 1:100

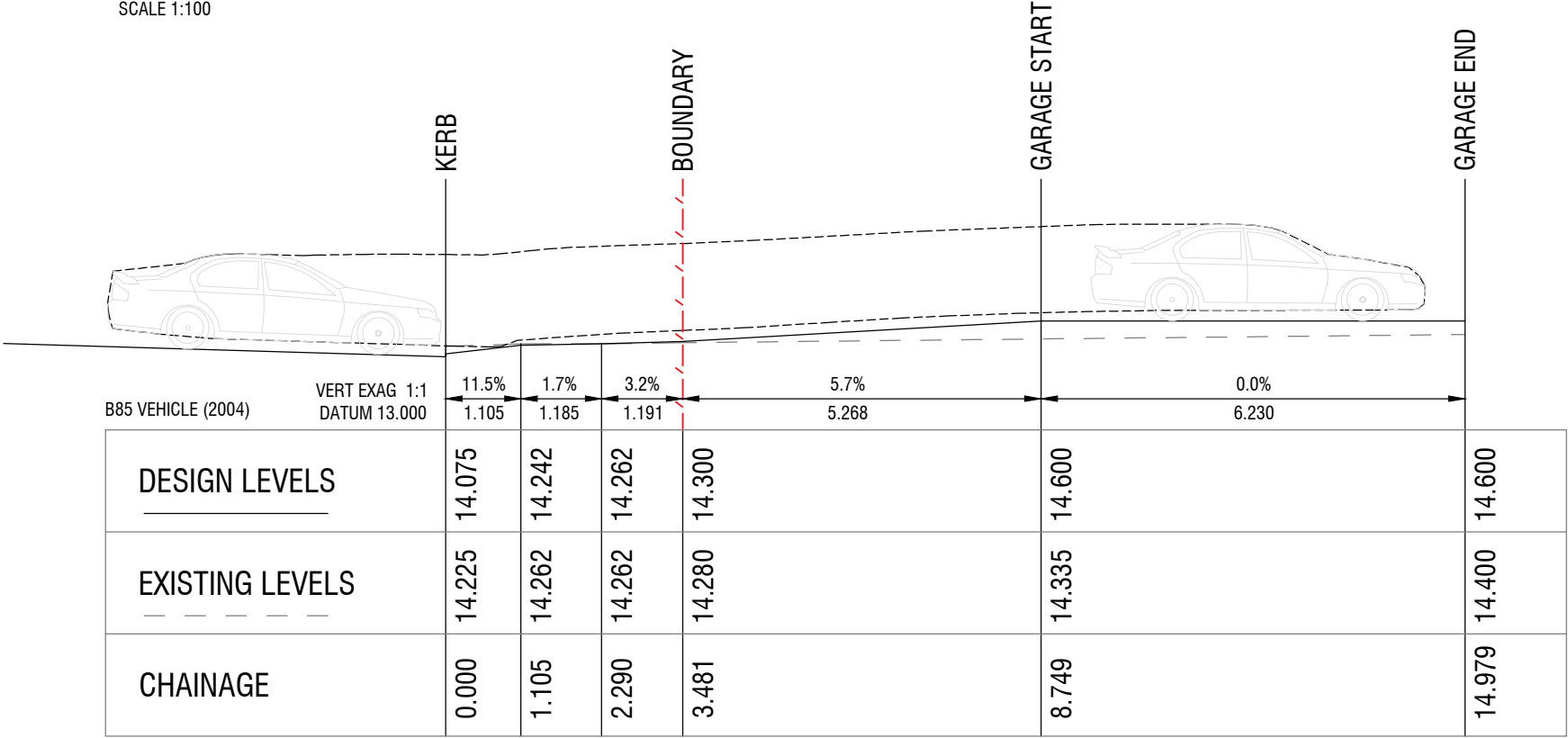

RHS ALIGNMENT LONG SECTION
SCALE 1:100

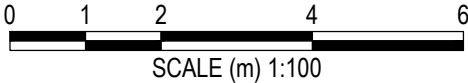

DRAWINGS TO BE PRINTED IN COLOUR

REV	DATE	AMENDMENT / REVISION DESCRIPTION	TITLE	NAME
A	14/01/2025	ISSUED FOR DA - DRIVEWAY	DRAWN	JP
B	06/06/2025	ISSUED FOR DA	DESIGNED	JP
			DRG CHECK	PH
			DESIGN CHECK	PH
			APPROVED	PH

IF IN DOUBT, ASK





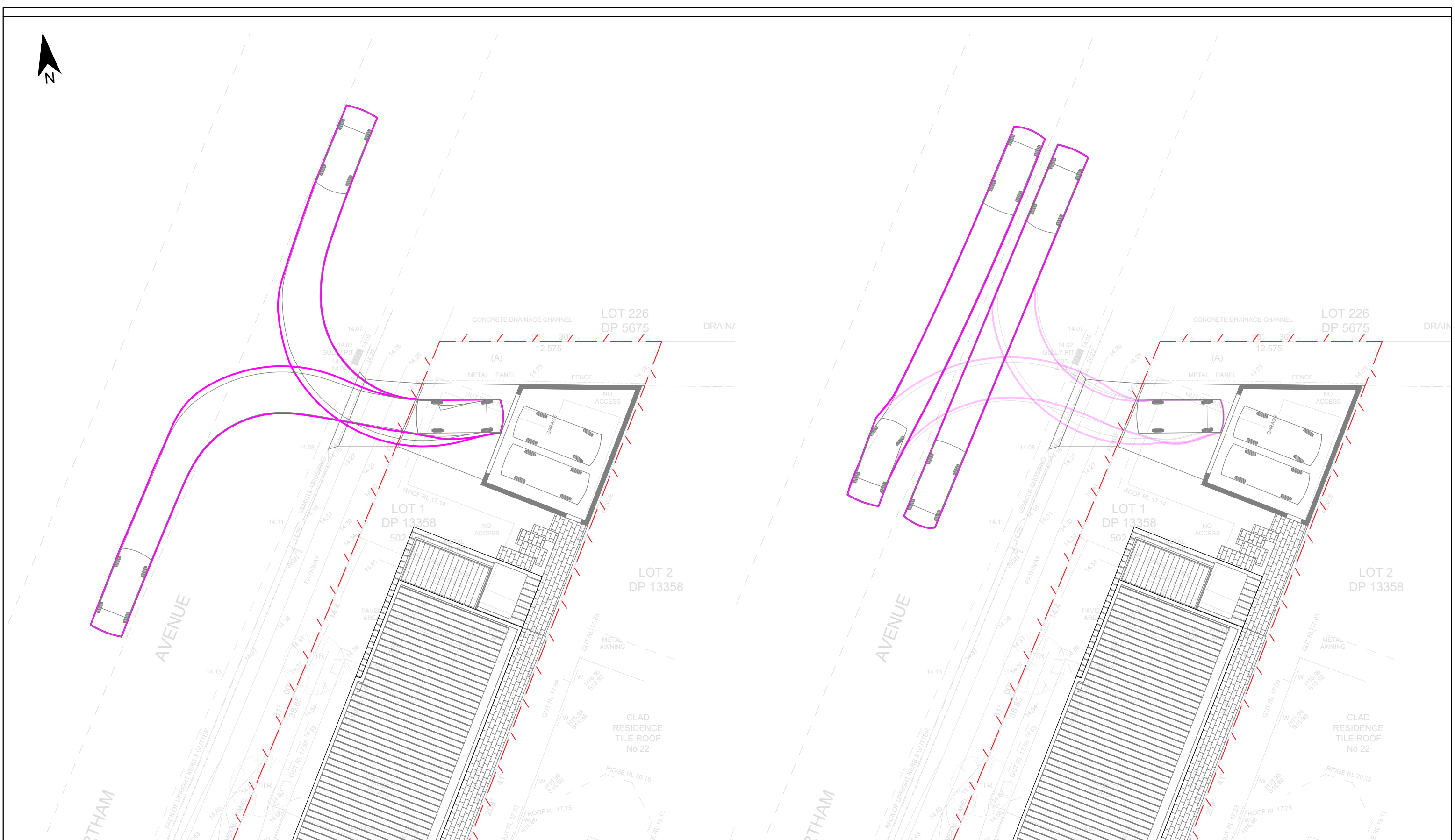

ISSUED FOR DA

SITE ADDRESS 23 CHELMSFORD AVE, BANKSTOWN				
CLIENT MINH TRAN				
LONG SECTIONS (SHEET 2 OF 2)				
THIS DRAWING AND THE INFORMATION CONTAINED THEREON HAVE BEEN CREATED SOLELY FOR A PARTICULAR PURPOSE AND CLIENT. THIS IS PROTECTED BY COPYRIGHT. YOU MAY NOT REPRODUCE ANY OF IT IN ANY FORM WITHOUT THE WRITTEN PERMISSION BY HYVE DESIGNS PTY LTD. IF YOU DO, YOU MAY HAVE TO PAY FOR DAMAGES TO HYVE DESIGNS PTY LTD OR YOU MAY BE PROSECUTED.				
JOB NUMBER: 24217	DATUM AHD	SCALE A3, 1:100	SHEET No DR03	REV B



SCALE 1:200



- | | |
|---|---------------------------|
|  | BODY OUTLINE - FORWARD |
|  | CHASSIS OUTLINE - FORWARD |
|  | BODY OUTLINE - REVERSE |
|  | CHASSIS OUTLINE - REVERSE |
|  | BOUNDARY LINE |

SCALE 1:200

REV	DATE	AMENDMENT / REVISION DESCRIPTION	TITLE	NAME
A	14/01/2025	ISSUED FOR DA - DRIVEWAY	DRAWN	JP
B	06/06/2025	ISSUED FOR DA	DESIGNED	JP
			DRG CHECK	PH
			DESIGN CHECK	PH
			APPROVED	PH

IF IN DOUBT, ASK

HYVE DESIGNS 

ISSUED FOR DA

SITE ADDRESS
23 CHELMSFORD AVE, BANKSTOWN

CLIENT
MINH TRAN

SWEPT PATHS (SHEET 1 OF 3)

THIS DRAWING AND THE INFORMATION CONTAINED THEREON HAVE BEEN CREATED SOLELY FOR A PARTICULAR PURPOSE AND CLIENT. THIS IS PROTECTED BY COPYRIGHT. YOU MAY NOT REPRODUCE ANY OF IT IN ANY FORM WITHOUT THE WRITTEN PERMISSION BY HYVE DESIGNS PTY LTD. IF YOU DO, YOU MAY HAVE TO PAY FOR DAMAGES TO HYVE DESIGNS PTY LTD OR YOU MAY BE PROSECUTED.

JOB NUMBER: 24217	DATUM AHD	SCALE A3, 1:200	SHEET No DR04	REV B
----------------------	--------------	--------------------	------------------	----------

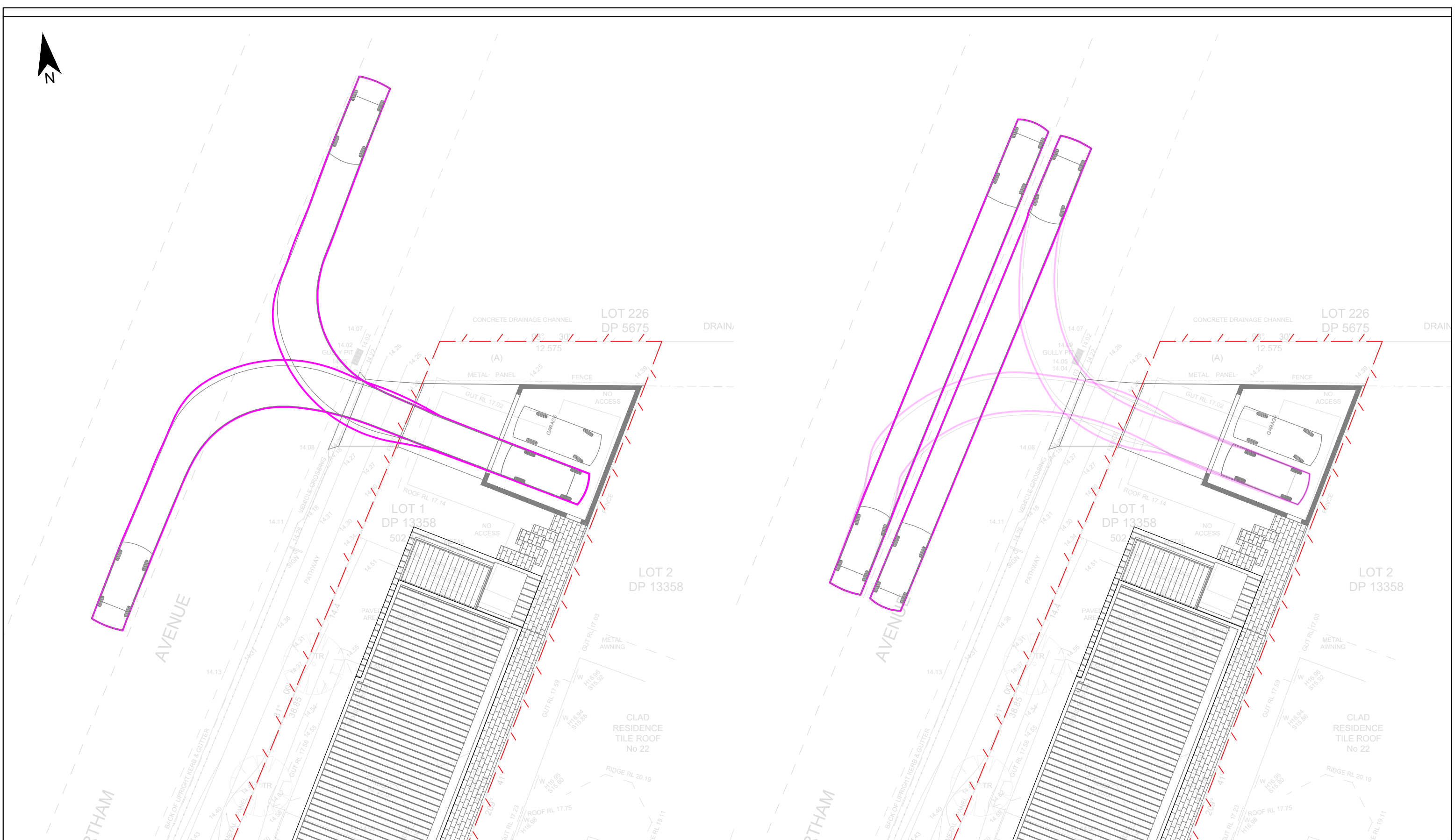

CAR PARK 2 - SWEEP PATH - IN

SCALE 1:200



SCALE (m) 1:200

LEGEND PROPOSED

- BODY OUTLINE - FORWARD
- CHASSIS OUTLINE - FORWARD
- BODY OUTLINE - REVERSE
- CHASSIS OUTLINE - REVERSE
- - - - BOUNDARY LINE

DRAWINGS TO BE PRINTED IN COLOUR

REV	DATE	AMENDMENT / REVISION DESCRIPTION
A	14/01/2025	ISSUED FOR DA - DRIVEWAY
B	06/06/2025	ISSUED FOR DA

TITLE	NAME
DRAWN	JP
DESIGNED	JP
DRG CHECK	PH
DESIGN CHECK	PH
APPROVED	PH

IF IN DOUBT, ASK

HYVE DESIGNS



SITE ADDRESS
23 CHELMSFORD AVE, BANKSTOWN

CLIENT
MINH TRAN

SWEEP PATHS (SHEET 2 OF 3)



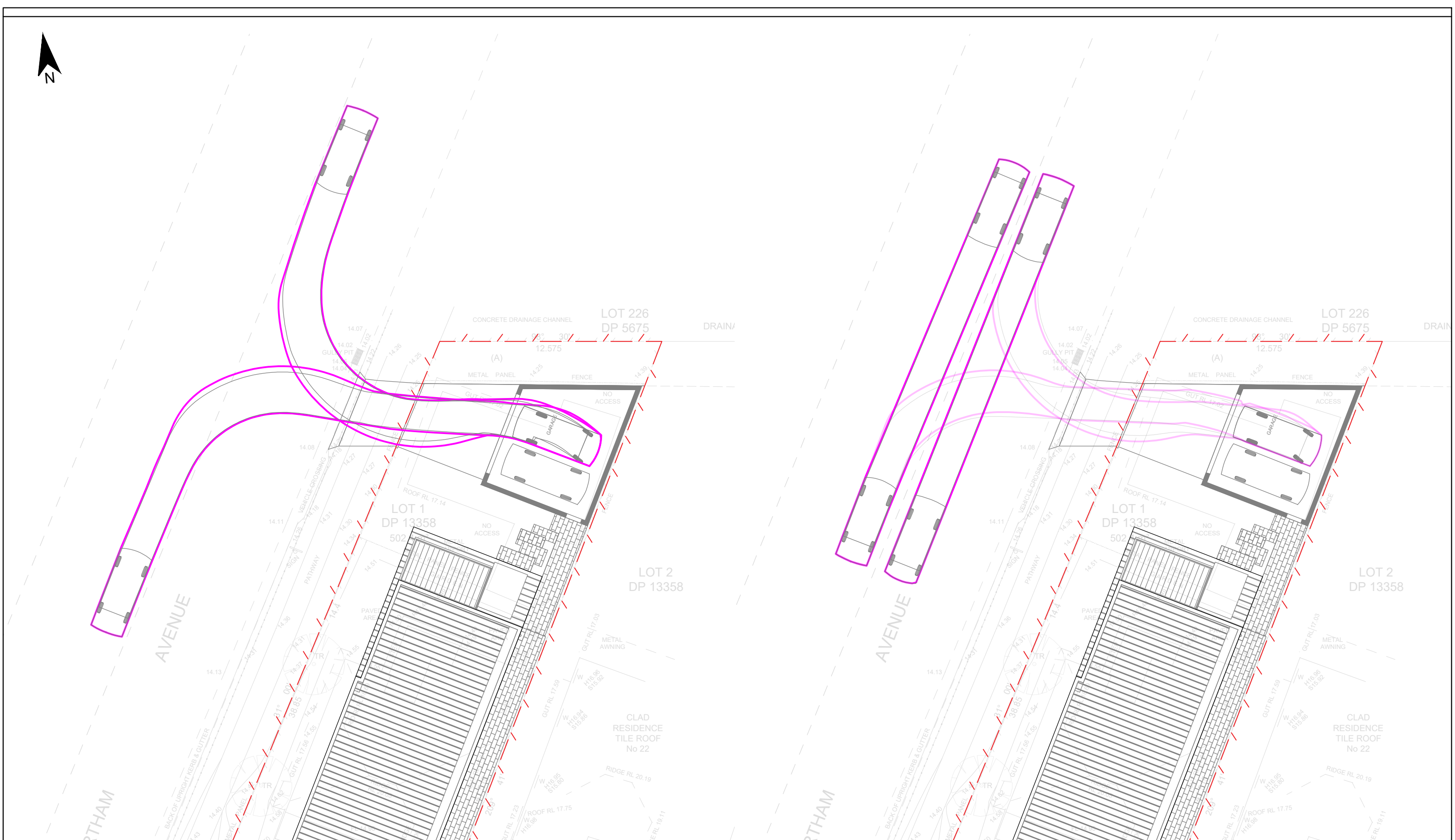

THIS DRAWING AND THE INFORMATION CONTAINED THEREON HAVE BEEN CREATED SOLELY FOR A PARTICULAR PURPOSE AND CLIENT. THIS IS PROTECTED BY COPYRIGHT. YOU MAY NOT REPRODUCE ANY OF IT IN ANY FORM WITHOUT THE WRITTEN PERMISSION BY HYVE DESIGNS PTY LTD. IF YOU DO, YOU MAY HAVE TO PAY FOR DAMAGES TO HYVE DESIGNS PTY LTD OR YOU MAY BE PROSECUTED.

JOB NUMBER: 24217	DATUM AHD	SCALE A3, 1:200	SHEET No DR05	REV B
----------------------	--------------	--------------------	------------------	----------



SCALE 1:200



- | | |
|---|---------------------------|
|  | BODY OUTLINE - FORWARD |
|  | CHASSIS OUTLINE - FORWARD |
|  | BODY OUTLINE - REVERSE |
|  | CHASSIS OUTLINE - REVERSE |
|  | BOUNDARY LINE |

SCALE 1:200

REV	DATE	AMENDMENT / REVISION DESCRIPTION	TITLE	NAME
A	14/01/2025	ISSUED FOR DA - DRIVEWAY	DRAWN	IP
B	06/06/2025	ISSUED FOR DA	DESIGNED	IP
			DRG CHECK	PH
			DESIGN CHECK	PH
			APPROVED	PH

IF IN DOUBT, ASK

HYVE DESIGNS 

ISSUED FOR DA

SITE ADDRESS
23 CHELMSFORD AVE, BANKSTOWN

CLIENT
MINH TRAN

SWEPT PATHS (SHEET 3 OF 3)

THIS DRAWING AND THE INFORMATION CONTAINED THEREON HAVE BEEN CREATED SOLELY FOR A PARTICULAR PURPOSE AND CLIENT. THIS IS PROTECTED BY COPYRIGHT. YOU MAY NOT REPRODUCE ANY OF IT IN ANY FORM WITHOUT THE WRITTEN PERMISSION BY HYVE DESIGNS PTY LTD. IF YOU DO, YOU MAY HAVE TO PAY FOR DAMAGES TO HYVE DESIGNS PTY LTD OR YOU MAY BE PROSECUTED.

JOB NUMBER: 24217	DATUM AHD	SCALE A3, 1:200	SHEET No DR06	REV B
----------------------	--------------	--------------------	------------------	----------

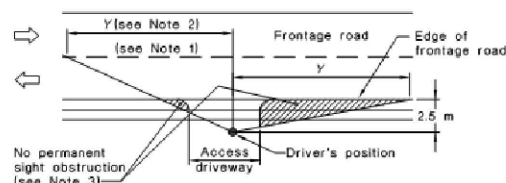

Frontage road speed (Note 4) km/h	Distance (Y) along frontage road m		
	Access driveways other than domestic (Note 5)		Domestic property access (Note 6)
	Desirable 5 s gap	Minimum SSD	
40	55	35	30
50	69	45	40
60	83	65	55
70	97	85	70
80	111	105	95
90	125	130	
100	139	160	Use values from 2 nd and 3 rd columns
110	153	190	

- Centre-line or centre of road (undivided road), or right hand edge of right hand through lane (divided road).
- A check to the left is not required at a divided road where the median is wide enough to shelter a vehicle leaving the driveway.
- Parking on this side of the frontage road may need to be restricted on either side of the driveway so that the sight distance required by the above table to an approaching vehicle is not obstructed.
- This is the posted or general speed limit nearest the 85th percentile speed is more than 5 km/h above the limit in which case the tabulated speed unless the 85th percentile should be adopted.
- The values in the table apply only to left turn and right turn manoeuvres into two-way roads up to four lanes wide and one-way roads regardless of width, either for a 5 g gap, desirable at lower frontage road speeds, or minimum stopping sight distance based on 2 s reaction time.
- Crossing manoeuvres (e.g. from an access opposite the stem of a T-junction) over four lanes or more, and turning manoeuvres into a six lane two-way road would require larger gaps unless there was a median wide enough to shelter a vehicle and allow a two stage manoeuvre.
- These distances are based on stopping sight distances with reaction time of 1.5 s for traffic approaching along the frontage road and are applicable to a frontage road speed of up to 80 km/h only. Wherever practicable sight distance provided at domestic property accesses should meet the values given in the second or third columns of the Table.
- When checking sight distance the driver's eye height and the height of the object (approaching vehicle) are to be taken as 1.15 m above the road surface.

FIGURE 3.2 SIGHT DISTANCE REQUIREMENTS AT ACCESS DRIVEWAYS

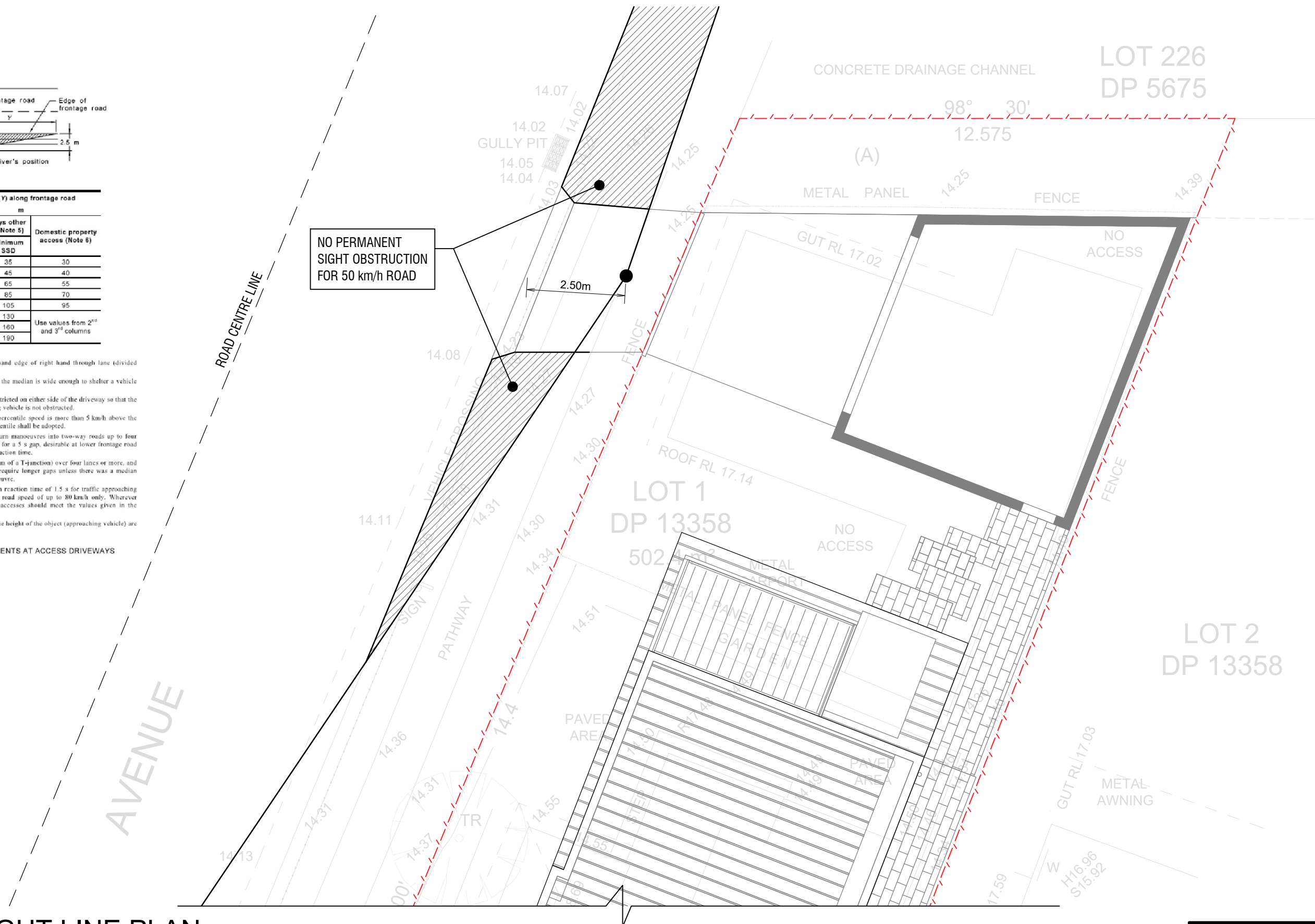

SCALE 1:100

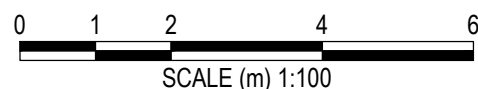

ISSUED FOR DA

DRAWINGS TO BE PRINTED IN COLOUR

REV	DATE	AMENDMENT / REVISION DESCRIPTION	TITLE	NAME
A	14/01/2025	ISSUED FOR DA - DRIVEWAY	DRAWN	JP
B	06/06/2025	ISSUED FOR DA	DESIGNED	JP
			DRG CHECK	PH
			DESIGN CHECK	PH
			APPROVED	PH

IF IN DOUBT, ASK

HYVE DESIGNS 

SITE ADDRESS
23 CHELMSFORD AVE, BANKSTOWN

CLIENT
MINH TRAN

DRIVEWAY SIGHT LINE PLAN

THIS DRAWING AND THE INFORMATION CONTAINED THEREON HAVE BEEN CREATED SOLELY FOR A PARTICULAR PURPOSE AND CLIENT. THIS IS PROTECTED BY COPYRIGHT. YOU MAY NOT REPRODUCE ANY OF IT IN ANY FORM WITHOUT THE WRITTEN PERMISSION BY HYVE DESIGNS PTY LTD. IF YOU DO, YOU MAY HAVE TO PAY FOR DAMAGES TO HYVE DESIGNS PTY LTD OR YOU MAY BE PROSECUTED.

JOB NUMBER: 24217	DATUM AHD	SCALE A3, 1:100	SHEET No DR07	REV B
----------------------	--------------	--------------------	------------------	----------